



**RETURN TO LOG SPLITTERS  
VALVE PARTS BREAKDOWN  
(390406A & 390406S)**

**Open center:** Fluid is constantly flowing, or cycling, through the valve and back to the tank (not through the whole log splitter system) pump is always running. Only goes to work when you actuate the valve or use the handle – like directing the fluid or getting the fluid to work for you.

**Closed center:** Valve acts like a switch – on or off. The pump on the tractor is what they call a “Variable Displacement Pump”. Pump senses when it needs flow.



Energy Mfg. Co., Inc.  
204 Plastic Lane, Monticello, Iowa 52110-9472  
Phone: (319) 485-3537  
FAX: (319) 455-5279  
Web Site: <http://www.energymfg.com>  
E-mail Address: [energy@IENet](mailto:energy@IENet)

MODEL C-908 DSKCVA-200  
4-WAY, OPEN CENTER, KICK-OFF  
PARTS LIST

**SpeeCo Replacement Parts:**  
HC 3904350 Bracket  
HC390429A - Handle  
HC390434 - Chain Link  
HC390442 - Spring Cap  
HC390423E - E-ring Kit  
HC390443 - Detent Assm.

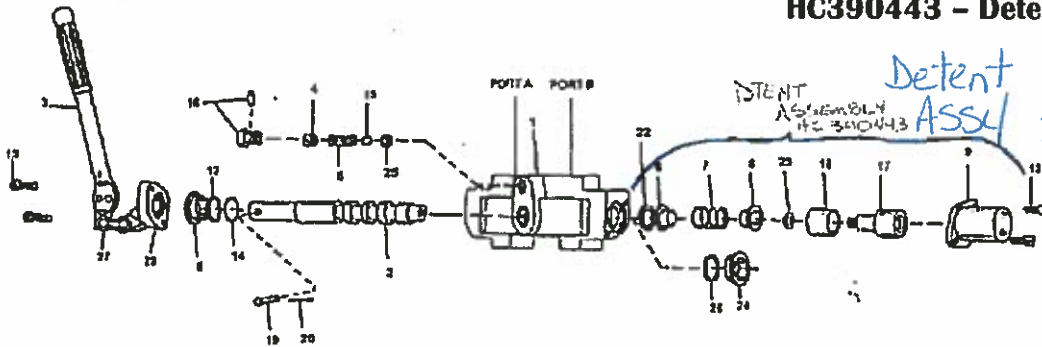

Item No.	Name	Qty.	Item No.	Name	Qty.
1	Control Valve Body	1	18	Spacer	1
2	Kickoff Valve Spool	1	19	Clevis Pin, 1/4 x 1	1
3	Control Handle	1	20	Cotter Pin, 3/32 x 1/2	1
4	Set Screw, 1/2-20 UNF	1	22	Washer, 5/8 x 1 DIA	1
5	Relief Valve Spring Assembly	1	23	Lock Washer, 5/16	1
6	Valve Spool Stop	2	24	Seal Retainer, 13/16 ID	1
7	Valve Spool Spring	1	25	Valve Seal	1
8	Seal Retainer 7/8 D	1	26	O-Ring, 13/16 ID x 1 1/16 OD	1
9	Spring Cover 7/8 D	1	27	Chain Link	1
12	Back Up Washer, 7/8 D	1	28	Control Lever Bracket	1
13	Screw	4	-	Seal Kit contains all seals used in valve	
14	O-Ring, 7/8 x 1-1/16 OD	1	-	Control Lever Assembly:	
15	Steel Ball	1		-Handle	
16	Plug, O-Ring, 1/2-20 UNF	1		- Grip	
17	Detent, Sub-Assy	1		- Chain Link	
				- Control Lever Bracket	